

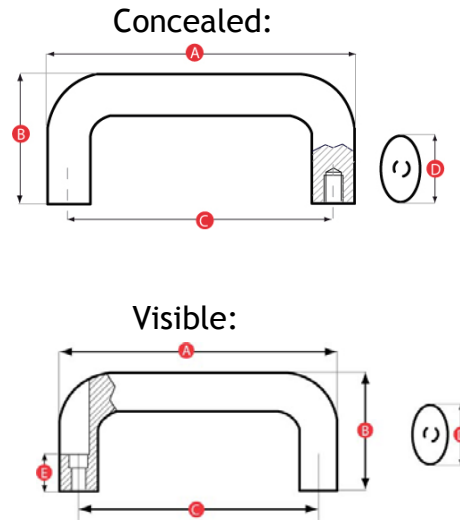

BRIDGE HANDLE - Aluminium



Pattern	Part No.	A	B	C	D	E	Thread size (for fixing from below)	Bore size (for fixing from above)
5100C	11804W	113	47	100	20		M6	
5112C	11805S	129	53	112	26		M8	
5128C	11806Z	141	51	128	20		M6	
5160C	11807V	177	57	160	26		M8	
5192C	11808R	209	57	192	26		M8	
5116V	11809Y	130	53	116	26	17		6.4mm
5132V	11810U	146	55	132	26	17		6.4mm
5164V	11811Q	178	57	164	26	17		6.4mm
5196V	11812X	210	57	196	26	17		6.4mm

Material: Powder coated die-cast aluminium
 Thread material: Aluminium
 Standard colour: Black
 Colour options: All RAL colours can be produced - MOQs apply

All our products are available in different materials (for example Polypropylene, ABS or different levels of glass filled nylon), with different insert materials (such as stainless steel, alloy or different zinc plating) and with different thread lengths and/or sizes. Please contact our Sales Team to see how we can help you save money AND get you exactly the product you need.

