

# Rencol

COMPONENTS

INDUSTRIAL MANUFACTURING SINCE 1923



# Rencol

## COMPONENTS

INDUSTRIAL MANUFACTURING  
SINCE 1923

*Rencol's flexible  
manufacturing capabilities,  
engineering expertise,  
global supply chain and  
market knowledge  
allow us to develop  
cost-effective product  
solutions that exceed our  
customers' expectations.*

## Who we are

In the early twentieth century Rencol developed engineered plastic solutions ranging from electric car batteries and recharging stations to the plastic "Joylight" internal combustion engine.

By the 1970s our focus on components had emerged and the Rencol name became synonymous with high quality plastic knobs, handles and handwheels.

### Today, we continue to grow, adapt and innovate:

- Our product range is extensive, industry-standard and growing.
- Our manufacturing partners are in key international locations, each chosen for their expertise, compatibility with our values and cost effectiveness.
- Our distribution network is worldwide and expanding.
- Our global supply chain has been in successful continuous operation for over a decade.

## We are here to help

Exceptional customer service is central to our company philosophy. Our customer service team, on-site engineers, product designers and supply chain experts are here to advise and assist at all stages of the purchase and fulfilment process.

### Call or email to:

- Check price and availability
- Make technical queries and request product advice
- Request samples
- Place and progress your order
- Request CAD drawings

### Visit our website to:

- Request a quotation
- View product specifications and MOQs
- Find your local distributor
- Request CAD drawings
- Request a catalogue

**Tel:** +44 (0) 117 916 0090

**Fax:** +44 (0) 117 982 2235

**Email:** [sales@rencol.com](mailto:sales@rencol.com)

**Website:** [www.rencol.com](http://www.rencol.com)

### Office opening hours:

Monday to Friday

8.30 AM to 5.00 PM (GMT)



*Nick Dowden, 30 years with Rencol.  
Customer Service Manager*

# Index

## Technical Specifications & Key

Material performance data, tolerances, colour options, quality certifications and product icon key.



Page 5

## Model 01 ML Adjustable Toggle Latch

Page 6

SS



## Model 02 ML Adjustable Toggle Latch

Page 7

SS



## Model 03 ML Stainless Steel Sprung Toggle Latch

Page 8

SS



## Model 04 ML Stainless Steel Variable Sprung Toggle Latch

Page 9

SS



## Model 05 ML Stainless Steel Sprung Toggle Latch

Page 10

SS



## Model 06 ML Diecast Zinc Lever-arm Compression Latch

Page 11



## Model 07 ML Diecast Zinc Cam Latch Cylinder Lock

Page 12



## Model 08 ML Zinc Plated Steel Camlock Latch

Page 13



## Model 09 ML Zinc Plated Steel Camlock Latch

Page 14



## Model 10 ML Quarter Turn Camlock with Key

Page 15



## Model 11 ML Quarter Turn Camlock for use with Padlock

Page 16



## Model 12 ML Quarter Turn Camlock

Page 17



## Model 01 PL Side Mount Screw-in Grabber Latch

Page 18



**Model 02 PL**  
**Snap-in Grabber Latch**

Page 19



**Model 03 PL**  
**Snap-in Slide Latch**

Page 20



**Model 04 PL**  
**Push-to-Close Camlock Latch**

Page 21



**Model 01 RL**  
**Rubber Latch**

Page 22

SS



**Model 01 MV**  
**Double Metal Vent**

Page 23

SS



**Model 02 MV**  
**Metal Vent**

Page 24

SS



**Modifications & Custom Components**

Custom colours, threads, materials, sizes, finishes, etc.

Page 27



## Technical Specifications & Key

### Thermoplastic

Material: Nylon 6 + Polypropylene (PP)

Working temperatures: Nylon up to 130°C peak and 80°C continuous use. Polypropylene maximum 70°C.

Resistant to: alcohols, esters, aromatic hydrocarbons, dilute alkalis, ketones, oils, fuels, grease, fats, weatherability (including UV light - excludes coloured Nylon) and salt water.

With PP also avoid halogenated hydrocarbons and flammable materials (can hold static charge).

### Reinforced Thermoplastic

Material: Nylon 6 glass filled

Working temperature: up to 180°C peak, 110°C continuous use.

Resistant to: alcohols, esters, aromatic hydrocarbons, dilute alkalis, ketones, oils, fuels, grease, fats, weatherability (including UV light) and salt water.

### Duroplast

Material: Phenolic Based Duroplast (PF)

Working temperature: -30°C to 160°C

Resistant to: diluted mineral acids, alcohols, chlorinated hydrocarbons, aromatic hydrocarbons, detergents, grease, oils, weatherability (including UV light). Avoid high pressure or high impact loads (can shatter).

### Soft-Touch Mouldings

Material: Polypropylene substrate, TPE over-mould. Rencol has standard parts already available in this design, used particularly extensively in both industrial and special needs market products.

### Brass

Material: BS2874 CZ121. Especially recommended for any materials likely to have continued exposure to temperatures below -30°C, where most steel grades become brittle. Also used as a marine grade material when nickel plated.

### Zinc Plated Steel

Material: EN1A leaded-bright zinc passivated.

### Stainless Steel

Material: Standard grade is 304. For medical, catering or marine use recommended grade is 316 - has high chloride resistance.

### Aluminium

Grades are 6061 and A380. Others available on request.

### Colours

Colour options include black, red, yellow, green, blue, white and grey. Other colours are available on request. If you would like to see the colours before ordering, samples can be provided free of charge.

### Thread Depths

Wherever possible thread depths are a minimum of 1.5 x the diameter of the thread.

### Tolerances

In general, our products are produced to the following tolerances:

Bore sizes:  $\pm 0.1\text{mm}$  (0.004in)

Outside dimensions:  $\pm 0.5\text{mm}$  (0.020in)

Male thread length:  $\pm 1\text{mm}$  (0.040in)

### Tightening Torque

All tightening torques are to Standard 0.5T, which assumes a metal screw fixed into a non-metallic substrate. If the mode of employment is metal to metal assume the tightening force should be double this value.

### Mounting Hardware

Screw shear values are calculated on the basis of the largest metric screw which will fit the bore.

### Load Values

Axial loads are parallel to the hinge pin. Radial loads are perpendicular to it.

**All values are approximate and for guidance only.**

## Key



**Colour options** - RAL colours on request.



**Heavy duty** - Particularly hard wearing item.



**Stainless steel** - Partly or totally stainless steel.



**Fixing from above**



**Fixing from below**



**Multi component build** - Assembly available.



**Soft touch** - TPE over mould. Oil resistant.



Rencol Components is **ISO 9001:2015 Certified**  
Our components are **REACH & RoHS Compliant**

SS

**Description**

Stainless steel adjustable toggle latch. Complete with catchplate.

**Material**

Stainless steel 304

**Finish**

Polished

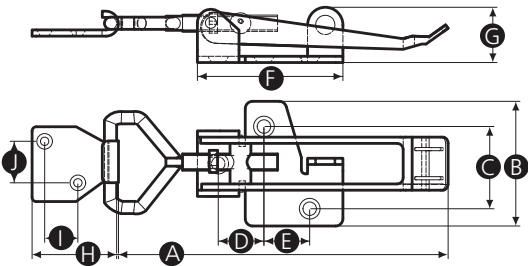
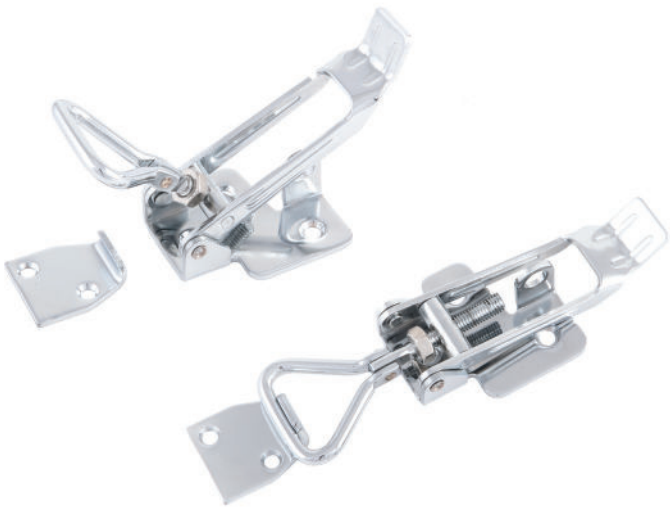

Part No.	A	B	C	D	E	F	G	H	I	J	Hole size
15429Y	162-190	60	34	22	22	70	27.6	34	16	20	6

SS

**Description**  
Stainless steel adjustable toggle latch. Complete with catchplate.

**Material**  
Stainless steel 304

**Finish**  
Polished

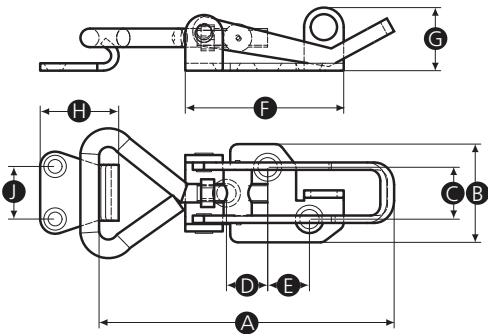

Part No.	A	B	C	D	E	F	G	H	I	J	Hole size
15430U	65-79	26.5	16.9	11.1	11.1	42.3	16.3	21.7	-	15.2	6
15940P	110-125	40	20	18	15	53	21	30	-	20	5



**SS**
**Description**

Stainless steel sprung toggle latch with or without hole for lock.  
Complete with catchplate.

**Material**

Stainless steel 304

**Finish**

Natural

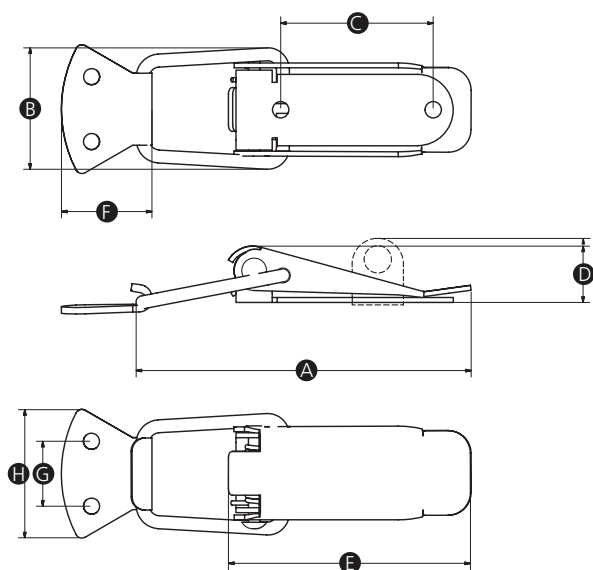

Part No.	A	B	C	D	E	F	G	H	Base hole size	Hook hole size	Locking hole size	Max load (N)
16068U	103	37	47	17	75	28	20	40	5	5	-	600
16070X	90	36	41	14	65	26	17	38	5	4	-	600
16072P	77	34	33	12	56	20	14	30	4	4	-	500
16074S	57	23	25	9	44	20	13	25	4	4	-	400
16069Q	103	39	47	20	75	28	20	40	5	5	8	600
16071T	90	36	41	17	65	26	17	38	5	4	5.5	600
16073W	76	34	33	13	56	20	14	30	4	4	5	500
16075Z	57	23	25	11	44	20	13	25	4	4	4.5	400



**SS**
**Description**

Stainless steel variable sprung toggle latch with or without hole for lock, and with or without extension plate. Complete with catchplate.

**Material**

Stainless steel 304

**Finish**

Natural

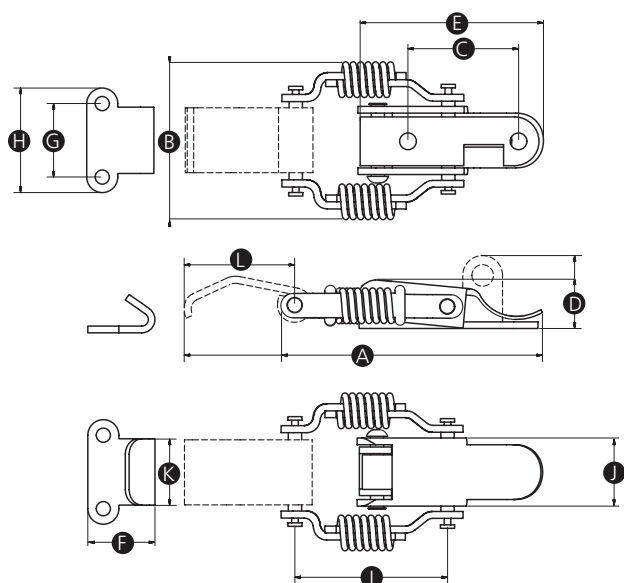

Part No.	A	B	C	D	E	F	G	H	I	J	K	L	Base hole Size	Hook hole size	Locking hole size	Max load (N)
16076V	58	36	13	11	42	15	17	24	35	15	15	-	4	3	-	700
16080Q	76	46	14 (x2)	15	62	26	25	37	43	24	21	-	5	5	-	1000
16078Y	58	36	25	17	42	15	17	24	35	15	15	-	4	3	5	700
16081X	76	46	28	22	62	26	25	37	43	24	21	-	5	5	5.5	1000
16077R	81	36	13	11	42	15	17	24	35	15	15	25	4	3	-	450
16079U	81	36	25	17	42	15	17	24	35	15	15	25	4	3	5	450

SS

**Description**

Stainless steel sprung toggle latch.

**Material**

Stainless steel 304

**Finish**

Natural

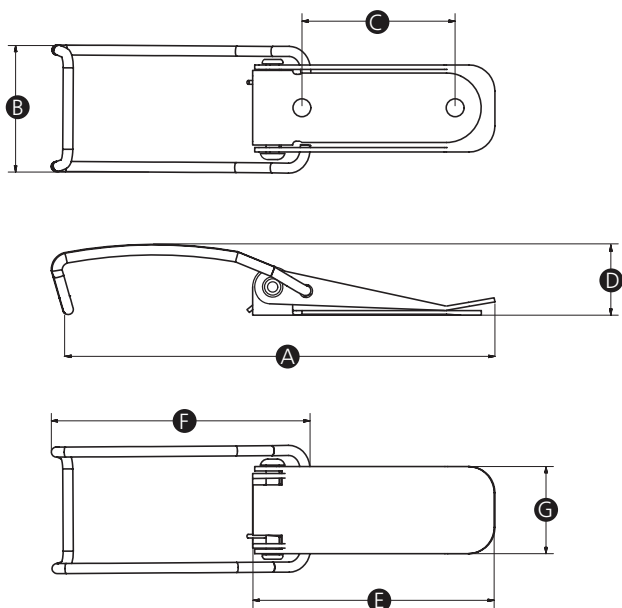

Part No.	A	B	C	D	E	F	G	Base hole size	Max. load (N)
16082T	119	34	41	19	65	69	23	5	500
16083P	103	34	41	16	65	54	23	5	400
16084W	88	21	25	21	45	55	16	4	900
16085S	69	22	25	18	43	38	17	4	1000

### Description

Quick open, easy assembly lever-arm compression latch. Screw adjusts for variable mounting distance. Locking item complete with key.

### Material

Die cast zinc housing, insert and handle. Zinc plated steel screw.

### Finish

Black powder coated housing, insert and handle. Plated screw.

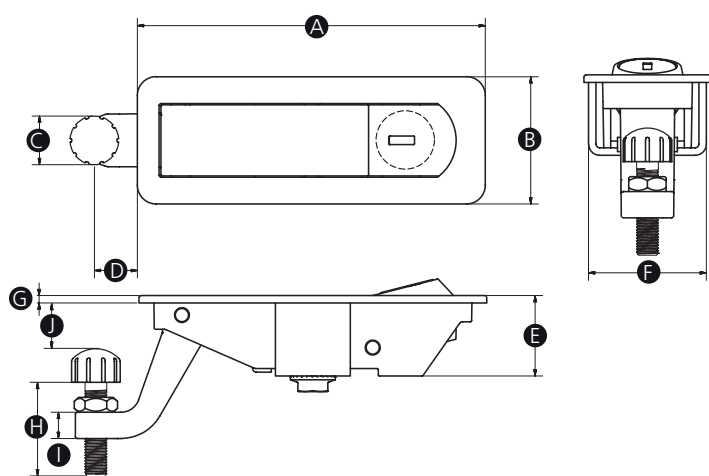

Part No.	A	B	C	D	E	F	G	H	I	Thread	Locking
15935Y	93	34	13	12	22	32	2	25	7	M6*0.75	Yes
15936U	93	34	13	12	22	32	2	25	7	M6*0.75	No

### Description

Cam quarter-turn to open or close, with locking function.  
Includes allen key.

### Material

Die cast zinc housing and insert, zinc plated steel cam.

### Finish

Black powder coated housing. Plated cam.



### Non-adjustable type

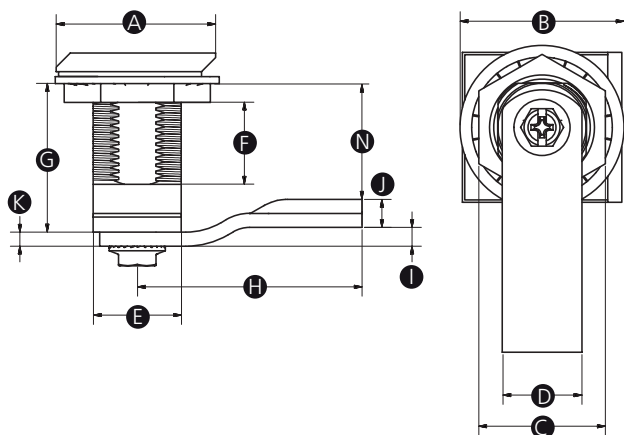

### Adjustable type

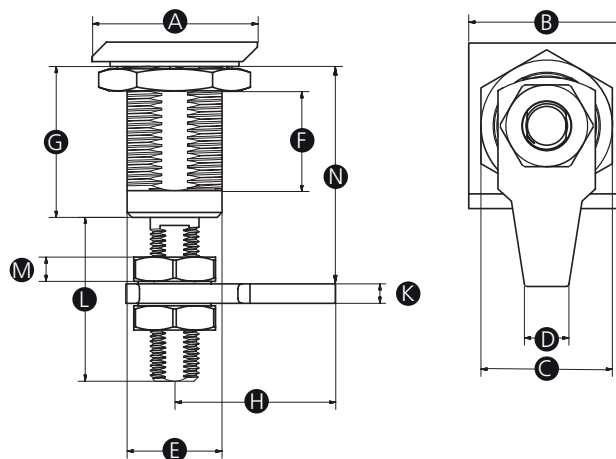

Part No.	A	B	C	D	E	F	G	H	I	J	K	L	M	N	Thread	Adjustable
15938X	34	35	27	17	19	18	32	48	4	6	3	-	-	25	1"-20 UNF	No
16144R	34	32	27	9	19	21	31	33	-	-	4	34	5	40-52	1"-20 UNF	Yes

### Description

Zinc plated steel 90° cam action lock. Available with square and key or slot.

### Material

Diecast zinc

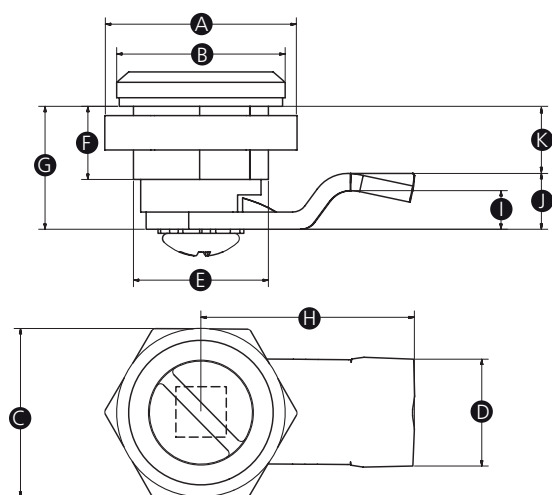

Part No.	A	B	C	D	E	F	G	H	I	J	K	Thread	Key type
15895T	22	20	20	13	16	9	14	25	4.5	6.5	7.5	M16*1mm	With slot
15931S	22	20	20	13	16	9	14	25	4.5	6.5	7.5	M16*1mm	With key

### Description

Quarter turn camlock. Available with multiple key and lock combinations and various cam sizes.

### Material

Stainless steel 304 or chrome plated die cast zinc

### IP rating

IP54: Dust protected / Protected against splashing water

Locks that require either a double bit key or tri-lock key do not come with a key as standard. Our part numbers for the keys are 16260X (double bit key) and 16261T (Tri-lock key).

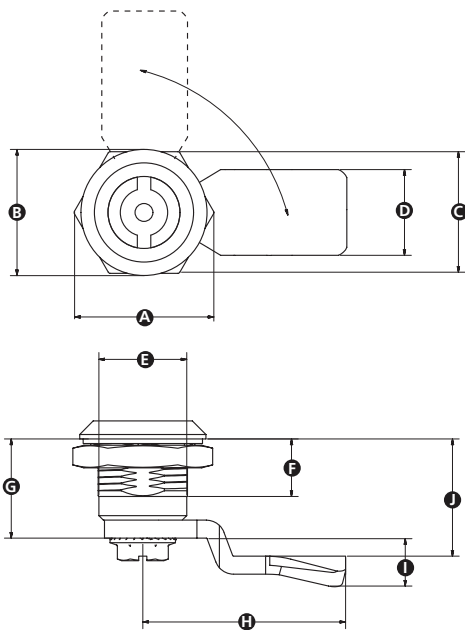

### Key type

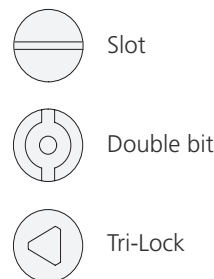

### Cut out

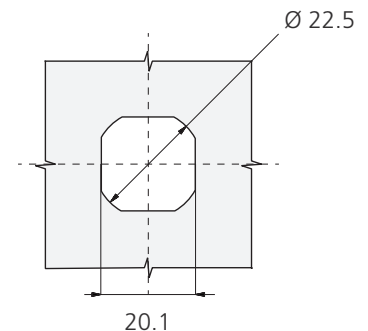

Part No.	A	B	C	D	E	F	G	H	I	J	Key type	Material
16145Y	31	28	27	19	20	13	22	45	17	32	Slot	Stainless steel
15881U	31	28	27	19	20	12	20	45	16	32	Double bit	Stainless steel
16248Q	31	28	27	19	20	13	22	45	11	26	Double bit	Die cast zinc
16249X	31	28	27	19	20	13	22	45	2	13	Double bit	Stainless steel
16250T	31	28	27	19	20	13	22	45	5	20	Double bit	Stainless steel
16251P	31	28	27	19	20	13	22	45	11	26	Double bit	Stainless steel
16252W	31	28	27	19	20	13	22	45	17	32	Double bit	Stainless steel
16253S	31	28	27	19	20	13	22	45	10	25	Tri-Lock	Die cast zinc
16254Z	31	28	27	19	20	13	22	45	2	13	Tri-Lock	Stainless steel
16255V	31	28	27	19	20	13	22	45	5	20	Tri-Lock	Stainless steel
16256R	31	28	27	19	20	13	22	45	11	26	Tri-Lock	Stainless steel
16257Y	31	28	27	19	20	13	22	45	16	32	Tri-Lock	Stainless steel

### Description

Chrome plated die cast zinc 90 degree RH/LH cam action lock with key

### Material

Chrome plated die cast zinc

### IP rating

IP54: Dust protected / Protected against splashing water

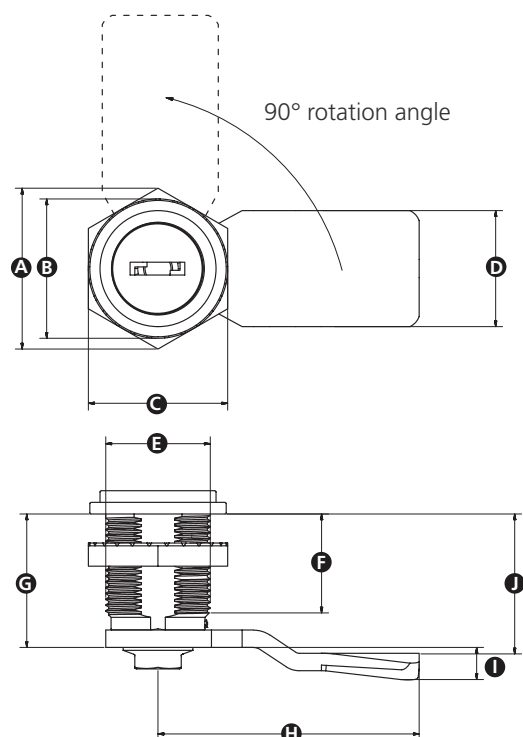

### Fitting direction

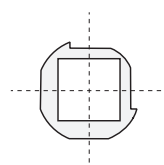

Integral device allows switching between right and left hand installation

### Cut out

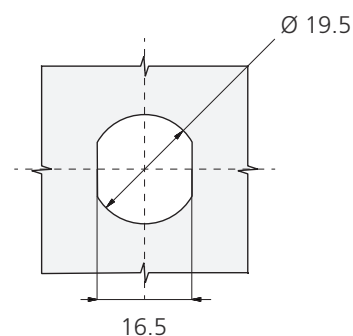

Part No.	A	B	C	D	E	F	G	H	I	J	Material
16258U	28	22	24	18	19	18	26	45	-	20	Die cast zinc
16259Q	28	24	24	20	18	17	23	45	5.5	24	Die cast zinc



**Description**

Use in conjunction with a padlock to provide increased security on cabinets and enclosures.

**Material**

Die cast zinc plated steel lock mechanism and black powder coated die cast zinc knob (16830X & 16829Q) or die cast zinc plated steel lock mechanism and powder coated blue/grey knob (16672R).

**IP rating**

IP54: Dust protected / Protected against splashing water

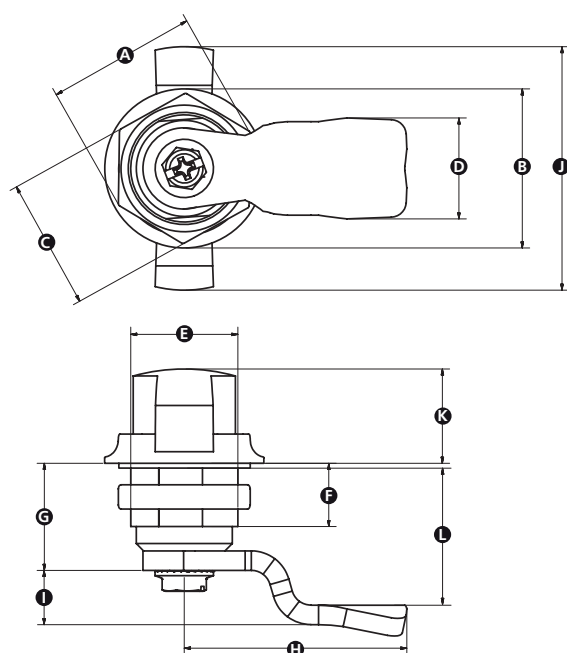
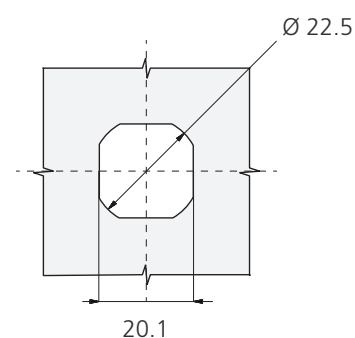
**Cut out**

Part No.	A	B	C	D	E	F	G	H	I	J	K	L
16830X	31	33	27	19	22	13	22	45	11	50	19	28
16672R	31	28	27	19.6	19.8	11.9	33	22.5	9.3	39.2	29.6	27
16829Q	31	33	27	19	22	13	22	45	11	50	19	6

**Material**

Die cast zinc plated steel lock mechanism and black powder coated die cast zinc knob

**IP rating**

IP54: Dust protected / Protected against splashing water

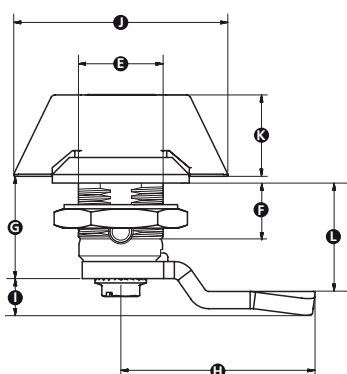
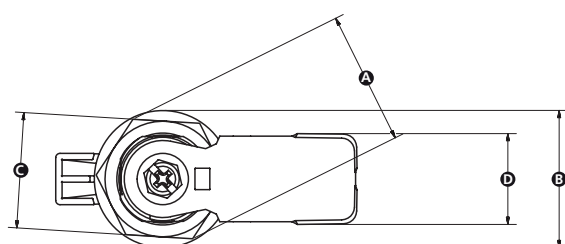
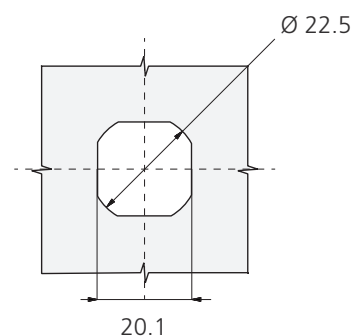
**Cut out**

Part No.	A	B	C	D	E	F	G	H	I	J	K	L	Type
16673Y	32	32	27	19	19.8	14.6	23.9	45	8.4	50	19	28	Key lock
16674U	32	32	27	19	19.8	14.6	23.9	45	8.4	50	19	28	No lock

**Description**

Push to close, pull to open latch with spring loaded over centre action.

**Material**

High impact resistant thermoplastic

**Finish**

Black

**Mounting**

Can be screwed or riveted to door/frame. Mounts inside enclosure.

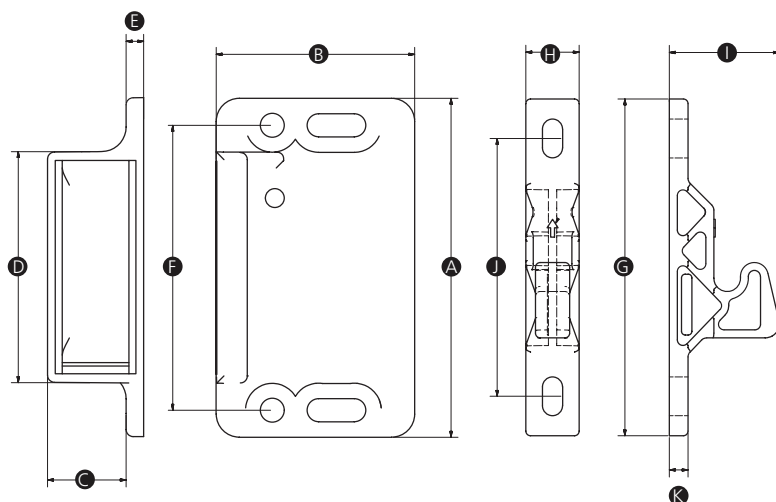

Part No.	A	B	C	D	E	F	G	H	I	J	K	Bore Size	Pull Force (N)
16055R	48	28	11	33	2.5	40.5	72	11.4	23.5	55	4	3.4, 3.4 x 8.4	13
16050P	48	28	11	33	2.5	40.5	72	11.4	23.5	55	4	3.4, 3.4 x 8.4	22
16056Y	48	28	11	33	2.5	40.5	72	11.4	23.5	55	4	3.4, 3.4 x 8.4	44

**Description**

Spring loaded, over-centre latches. Catch snaps into frame. Pull to open.

**Material**

ABS polycarbonate housing, high impact resistant thermoplastic keeper.

**Finish**

Black

**Mounting**

Snap-in to door/frame.

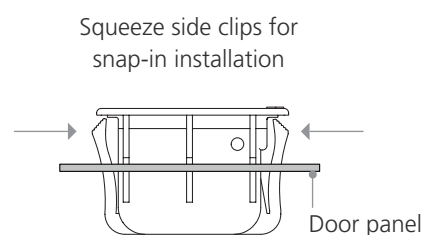
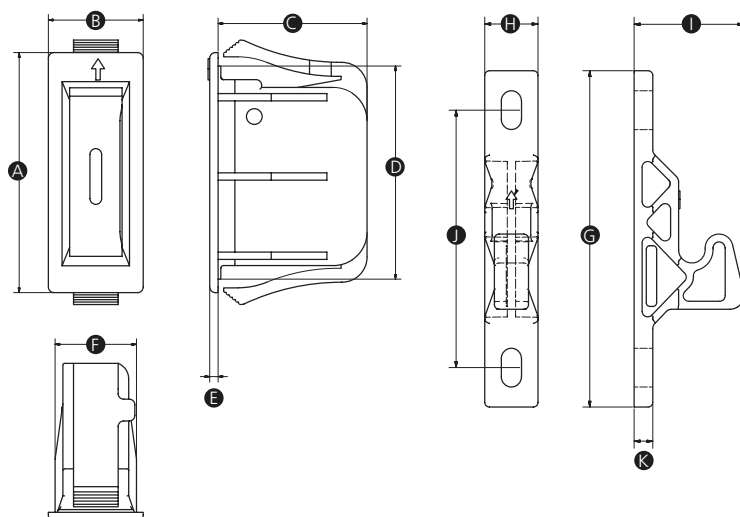

Part No.	A	B	C	D	E	F	G	H	I	J	K	Bore Size	Pull Force (N)
16057U	43	17	27	38	1.5	14.5	72	11.4	23.5	55	4	4.3 x 8.3	44

**Description**

Snap-in slide latch with 6mm slide movement.

**Material**

5% glass filled PA66

**Mounting**

Simple snap-in installation.

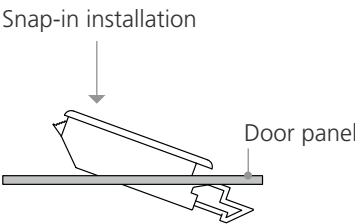
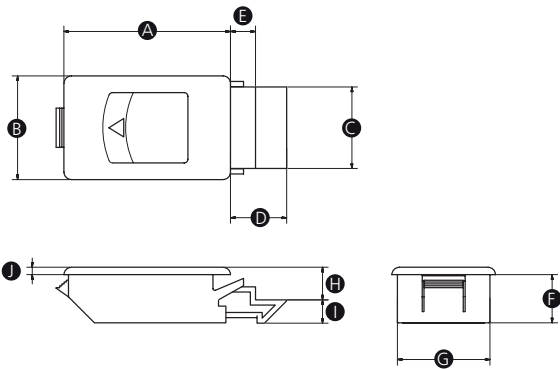

Part No.	A	B	C	D	E	F	G	H	I	J	Colour
15934R	45	28	22	15	7	13	25	9	6.5	2	Black
16142Z	45	28	22	15	7	13	25	9	6.5	2	White

**Description**

Automatic lock with push button opening. Includes 2x keys, catcher and handle pull.

**Material**

Polycarbonate

**Finish**

Black

**Mounting**

Hex shape screw down pressure plate.

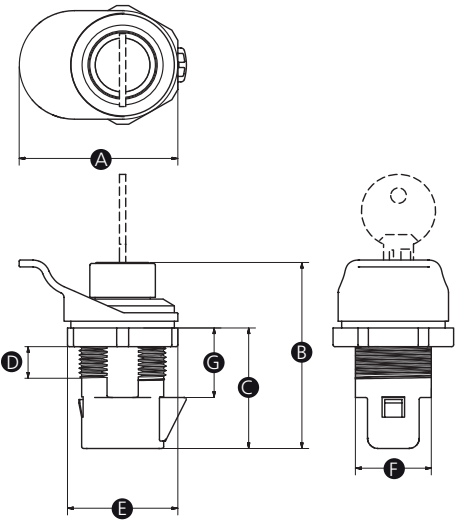

Part No.	A	B	C	D	E	F	Thread	Locking
15937Q	46	55	36	9	32	22	1"–20 UNF	Yes
16143V	46	55	36	9	32	22	1"–20 UNF	No

SS

### Material

Stainless steel catch and hinge. Chloroprene rubber latch.  
Chloroprene has excellent oil, chemical, heat, ozone & weather aging resistance, and low flammability.

### Temperature

-30°C to 100°C (short periods from -40°C up to 120°C)

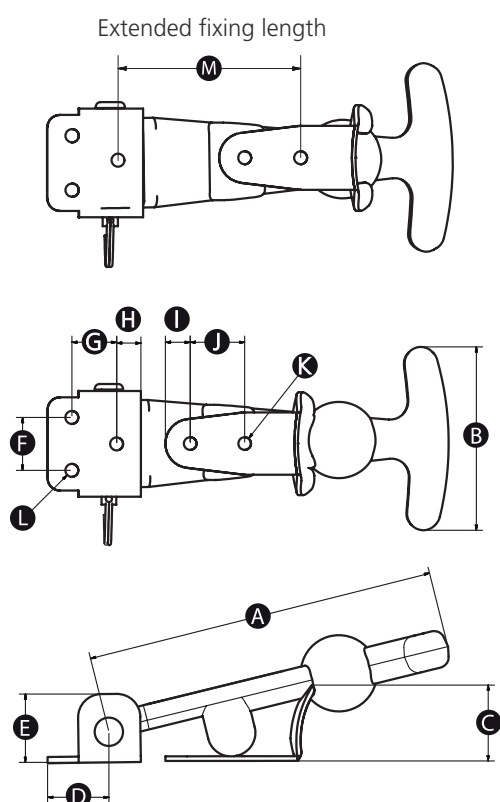

Part No.	A	B	C	D	E	F	G	H	I	J	K	L	M
16892R	112	59	24.5	20.2	22	16.5	15	7.5	8	17.5	4.1	4.2	57



SS

**Description**

Polished double vent

**Material**

Stainless steel 304

**Finish**

Electrolytic polish

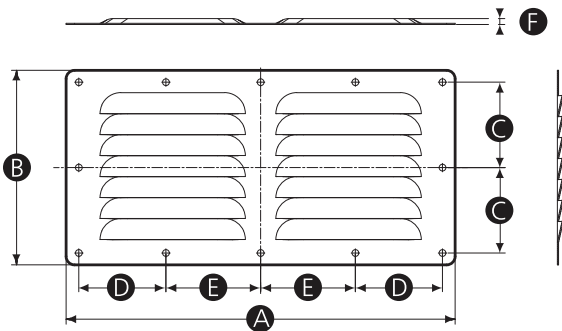

Part No.	A	B	C	D	E	F	Hole size
15426Z	230	115	50.5	51.5	56	3.5	4

Part No.	Free Space (mm <sup>2</sup> )	Flow at 1 Pascal Diff Pressure (mm <sup>3</sup> /sec)
15426Z	3530	2800

SS

**Description**

Polished single vent

**Material**

Stainless steel 304

**Finish**

Electrolytic polish

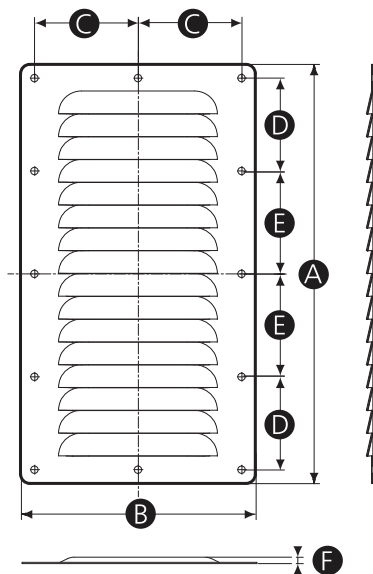

Part No.	A	B	C	D	E	F	Hole size
15428R	67	127	56	50.5	-	3.5	4
15427V	115	127	56	50.5	-	3.5	4
15425S	228	127	56	53.5	56	3.5	4

Part No.	Free Space (mm <sup>2</sup> )	Flow at 1 Pascal Diff Pressure (mm <sup>3</sup> /sec)
15428R	756	600
15427V	1764	1400
15425S	4032	3175



A large rectangular area filled with a light gray grid, resembling graph paper, intended for taking notes.

## Modifications & Custom Components

Diverse manufacturing capabilities and experienced on-site technical personnel allows Rencol Components to offer a wide range of product modifications and custom product solutions. We regularly adapt standard components or manufacture custom products to suit our customers' specific requirements. New tooling can be produced quickly and cost effectively with a typical MOQ of just 500 pieces.

### Manufacturing Processes

Plastic & Metal Injection Moulding / Die casting / Machining / Forging / Stamping / Rapid Prototyping / 3D Printing

### Modifications & Custom Options

Thread size & length / RAL Colours / Engraving / Pad-Printing & Screen-Printing / TPE Over mould / Materials / Finishes / Logos

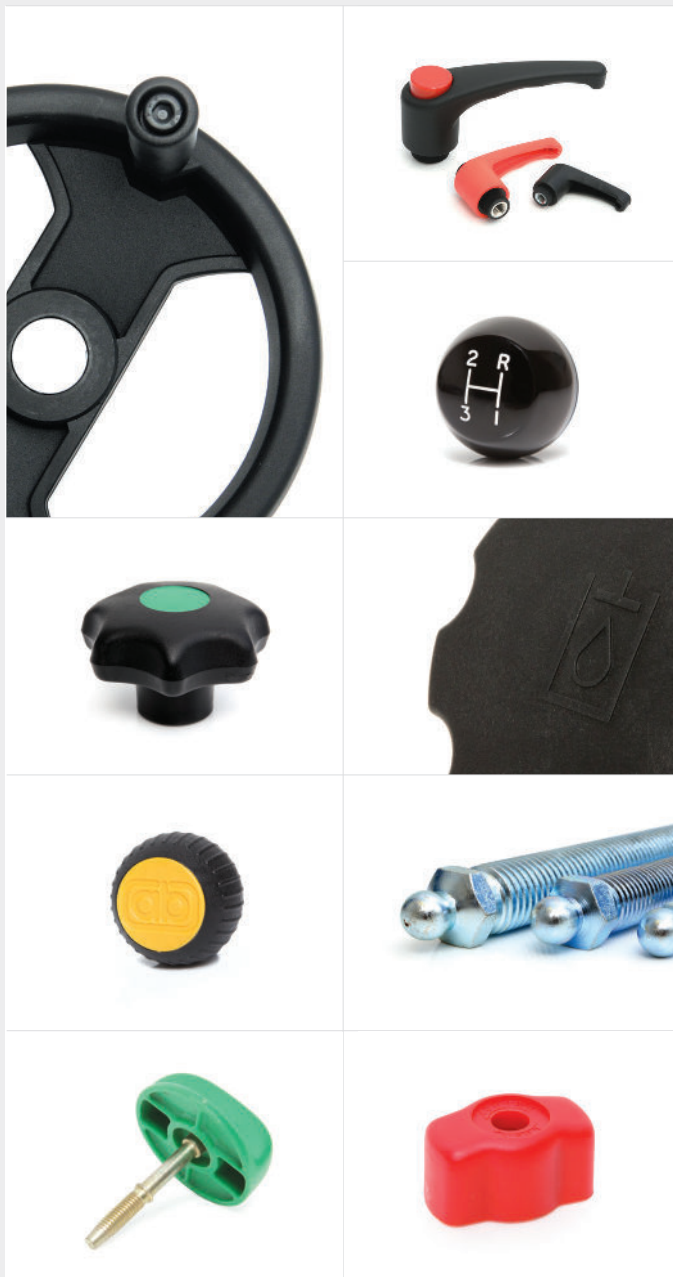



## **Rencol** COMPONENTS

**UK Head Office:**

Unit 2 Avonbridge Trading Estate  
Atlantic Road  
Avonmouth  
Bristol BS11 9QD  
United Kingdom

**Tel:** +44 (0) 117 916 0090

**Fax:** +44 (0) 117 982 2235

**Email:** [sales@rencol.com](mailto:sales@rencol.com)

**Website:** [www.rencol.com](http://www.rencol.com)

**Office opening hours:**

Monday to Friday  
8.30 AM to 5.00 PM (GMT)