



Material

Die cast aluminium

Pin material

Stainless steel - 304

Finish

Powder coated

Colour

Black

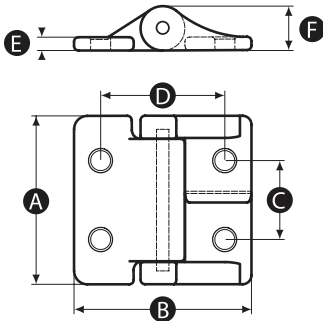

Part No.	A	B	C	D	E	F	Bore size (mm)
15744S	38	40	18	28	3	10	4.5

Part No.	Hinge torque (Nm)	Radial load (N)	Axial load (N)	Recommended tightening torque (Nm)	Approx. shear force per screw (kN)
15744S	0.4	1100	2100	1.5	0.28